

## AP6037 AppLight 6037

Countertop - wall hung basin 60x37 cm

• WITH OVERFLOW • ARRANGED FOR THREE TAP HOLES

Complements: **Chromed towel holder (PMW60)**  
**Line taps basin: ONE - NOKÉ - SI - FOLD - X1**  
**Line accessories: TWO - HOOP - NOKÉ - FOLD**

Technical accessories: **Chrome siphon (SIFL/CR) - Telescopic chrome siphon (SIFL066)**  
**Stop & Go drain (PLSG)**  
**CERAMIC Stop & Go drain (PLCE)**  
**Two piece set chrome tap filters (RF026)**

Package dim.

Weight 15 kg

Pz. Pallet n° -

CE UNI EN 14688 - CL20 Dop-No14688

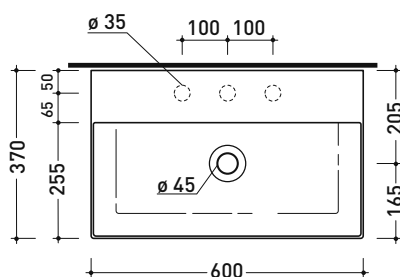

vista zenitale / zenital view

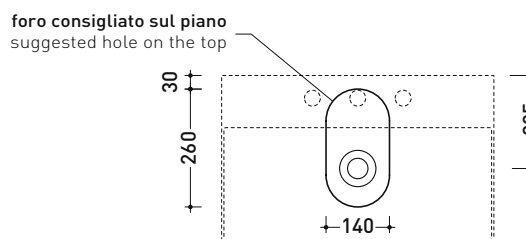

vista zenitale / zenital view

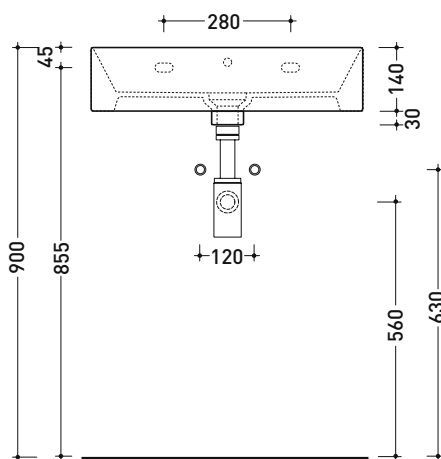

vista frontale / frontal view

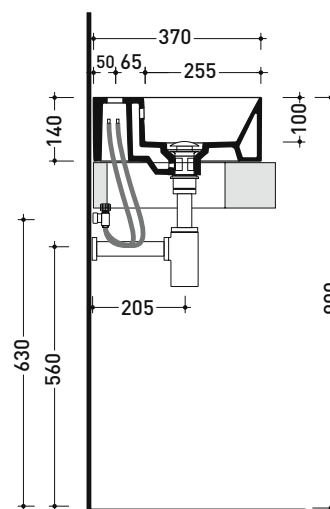

sezione longitudinale / section

sizes in mm

Please consider a 2% tolerance on indicated measurements

CERAMIC: glossy finish

matt finish



white



milky white



carbone